

千葉土木 L 型

基本

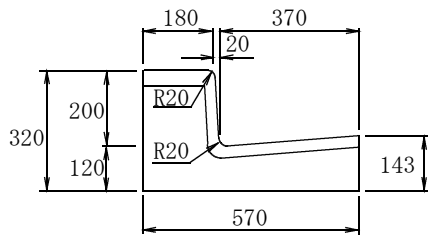

ℓ=600 参考重量160kg

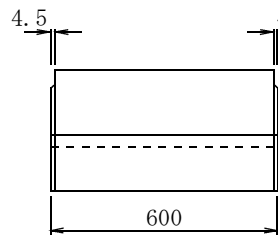

ℓ=2000 参考重量534kg

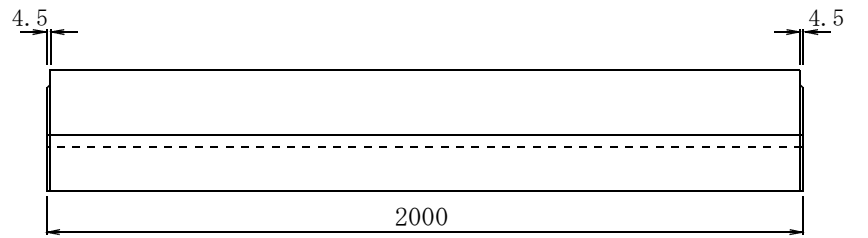

縁塊 参考重量148kg

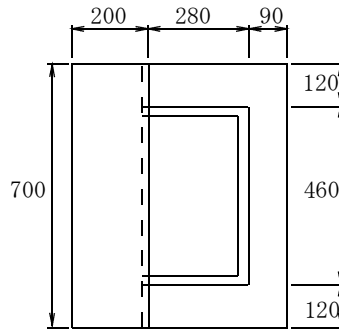
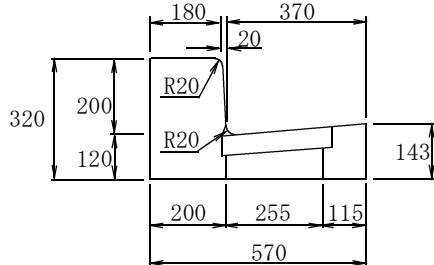

平(MD170)参考重量114kg

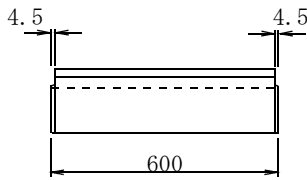
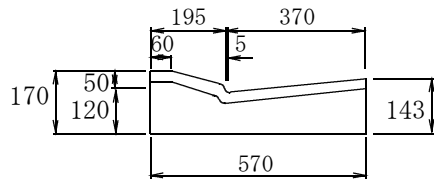

平(140)参考重量110kg

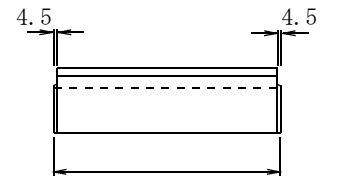
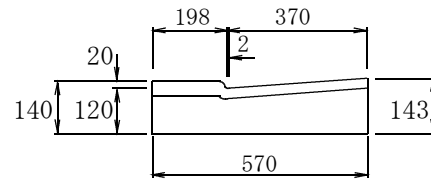

斜(MD170)参考重量139kg

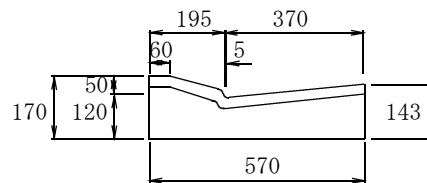
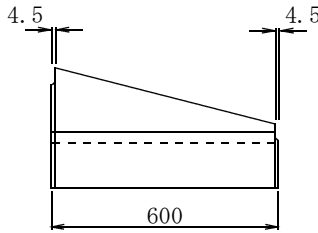
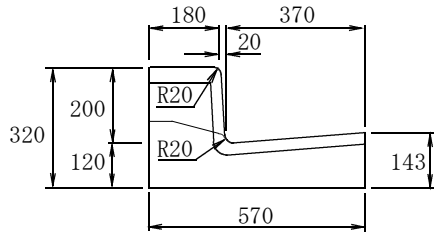

斜(140)参考重量136kg

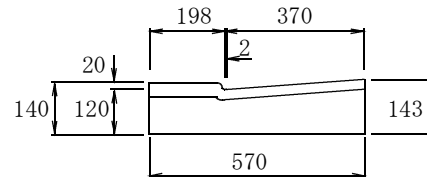
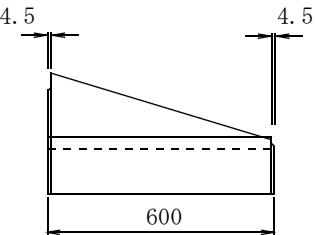
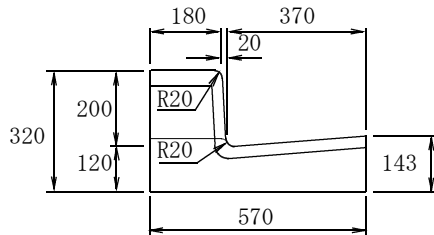

3段斜(MD170)

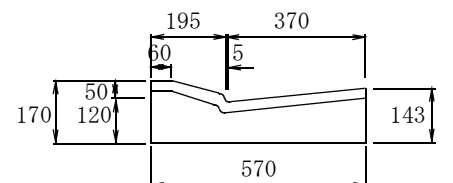
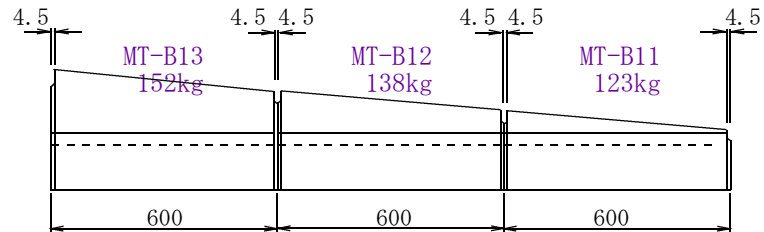
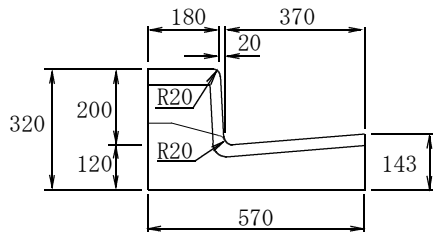

3段斜(140)

